



# FA MILY KIT

A kit for grownups and children  
aged 5 and over to share while  
exploring the exhibition

**OLAFUR ELIASSON  
NEL TUO TEMPO**



The exhibition you're about to visit showcases the work of Olafur Eliasson, a contemporary artist who was born in Copenhagen and grew up in Iceland and Denmark.

Today he's 55 years old and lives in Berlin where he works with a team of artisans, architects, cooks, art historians and technicians.

Olafur's riveting work made of light, reflection and colour urges you to explore spaces and to look at them in a different way.

In Palazzo Strozzi his work transforms the rooms: it's time to go and discover them!

To find your way around the exhibition rooms, the easiest thing is to follow the map on the back of the Kit.



When Eliasson toured Palazzo Strozzi for the first time, he was so struck by its huge windows that he decided to use them to create new works of art which he designed especially for this exhibition.

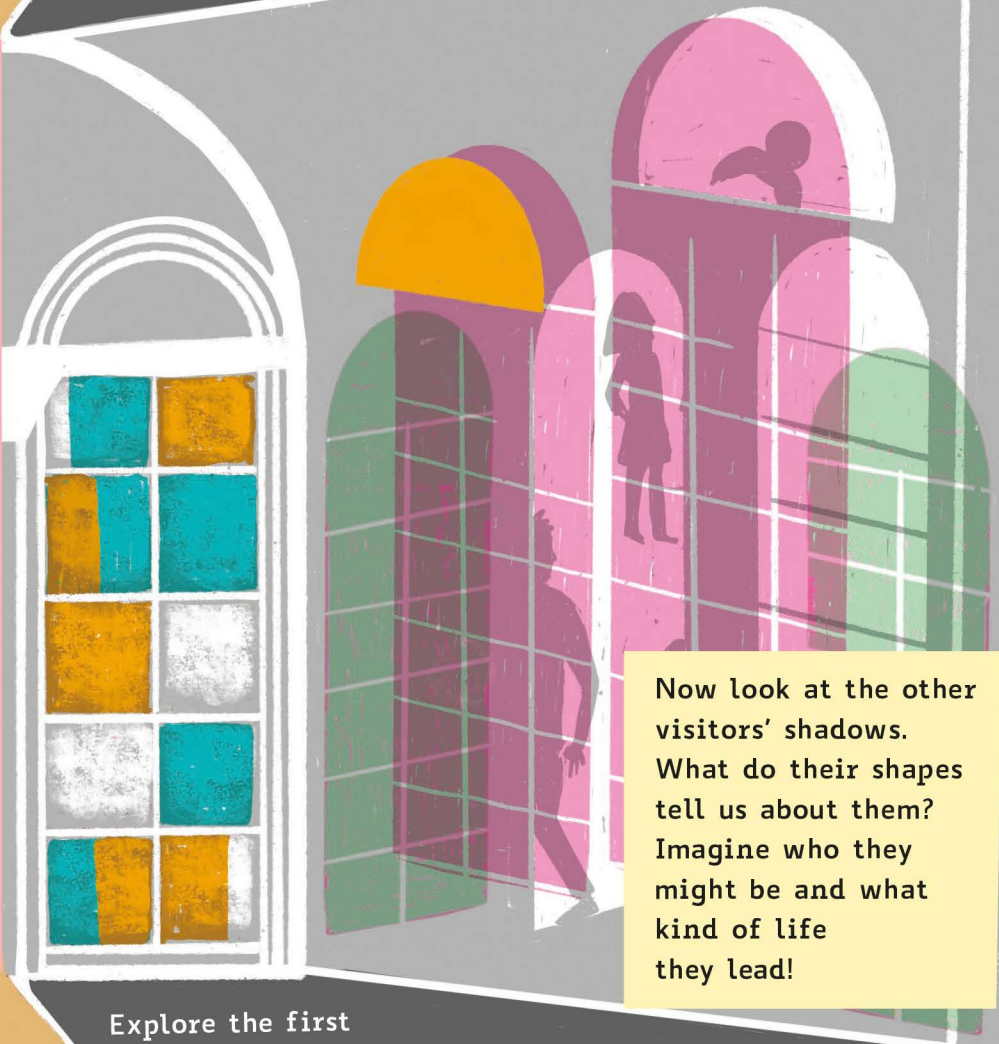

Now look at the other visitors' shadows. What do their shapes tell us about them? Imagine who they might be and what kind of life they lead!

Explore the first three rooms and look at the shapes, colours and reflections of these "pictures made of light". Move around the rooms, "go into" the exhibits and focus on your own shadow. What do you think you look like?

- 2 Triple seeing survey, 2022
- 3 Tomorrow, 2022
- 4 Just before now, 2022



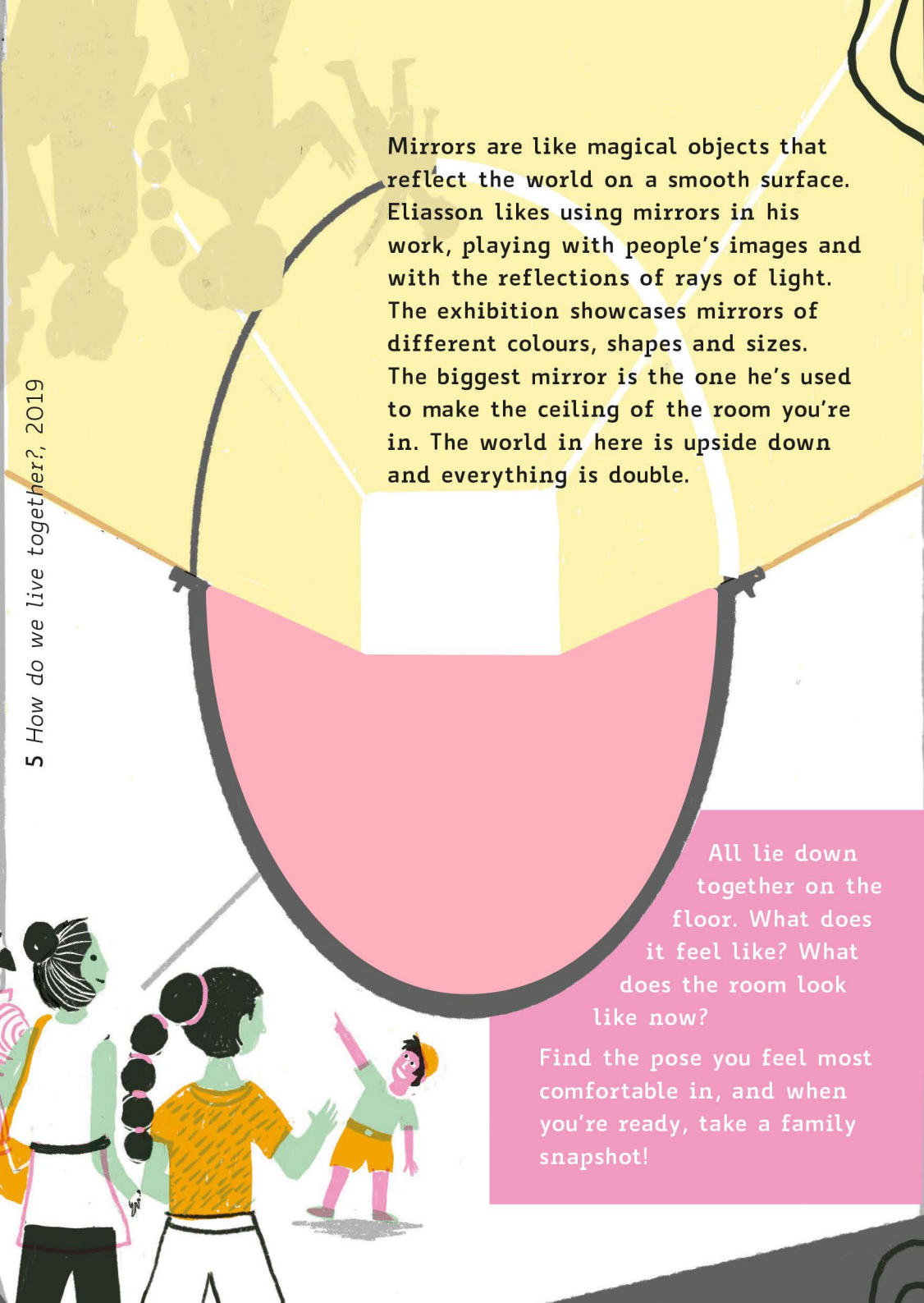

Mirrors are like magical objects that reflect the world on a smooth surface. Eliasson likes using mirrors in his work, playing with people's images and with the reflections of rays of light. The exhibition showcases mirrors of different colours, shapes and sizes. The biggest mirror is the one he's used to make the ceiling of the room you're in. The world in here is upside down and everything is double.

All lie down together on the floor. What does it feel like? What does the room look like now?

Find the pose you feel most comfortable in, and when you're ready, take a family snapshot!

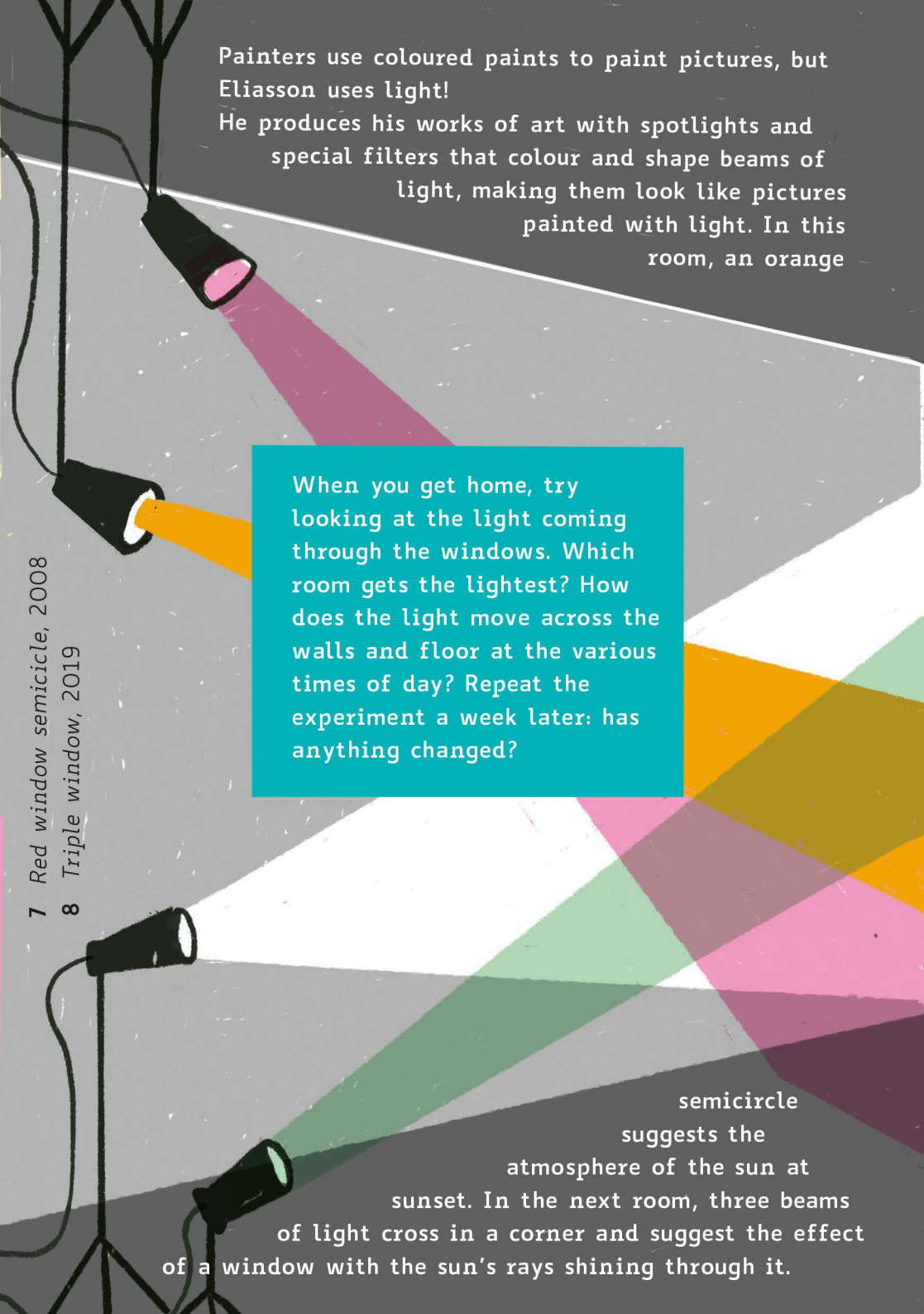

Painters use coloured paints to paint pictures, but Eliasson uses light!

He produces his works of art with spotlights and special filters that colour and shape beams of light, making them look like pictures painted with light. In this room, an orange

When you get home, try looking at the light coming through the windows. Which room gets the lightest? How does the light move across the walls and floor at the various times of day? Repeat the experiment a week later: has anything changed?

7 Red window semicircle, 2008

8 Triple window, 2019

semicircle suggests the atmosphere of the sun at sunset. In the next room, three beams of light cross in a corner and suggest the effect of a window with the sun's rays shining through it.

A beam of light meets a wall made up of tiny droplets of water falling from the ceiling, making colours appear as though by magic! This is exactly the same phenomenon you see in the sky when a rainbow forms after a thunderstorm.

9 Beauty, 1993

Try out different positions in the room: sometimes you can make out the colours really well, other times they simply disappear. And they don't all look the same to everyone. This work of art looks totally different to each visitor. What colours can you make out?

What happens when someone walks through the droplets? Why don't you try out this colourful shower too?!

Eliasson loves using coloured sources to create complex geometrical shapes. There are two works of art in this room. One of them is hanging from the ceiling, slowly turning, and with so many faces it feels like it's impossible to count them all.

10 Colour spectrum kaleidoscope;  
Fire double polyhedron  
sphere experiment, 2022

Stand  
at the smaller  
end and have someone take a photo  
of you! How many times is your image  
reflected inside the "kaleidoscope"?

The other one looks like a telescope with six sides and open ends, resting on a base. Eliasson calls it his "kaleidoscope".

If you use the hole to frame details of the people around you, what do you see?

In this room a special light turns everything you can see into shades of yellow, black, and grey. All the others colours simply disappear! Can you read what it says below?

**"We don't need to be equal to share the same space**

Olafur Eliasson

Our eyesight slowly gets used to this light and our attention shifts to the skin, the weave of the fabrics and the forms.

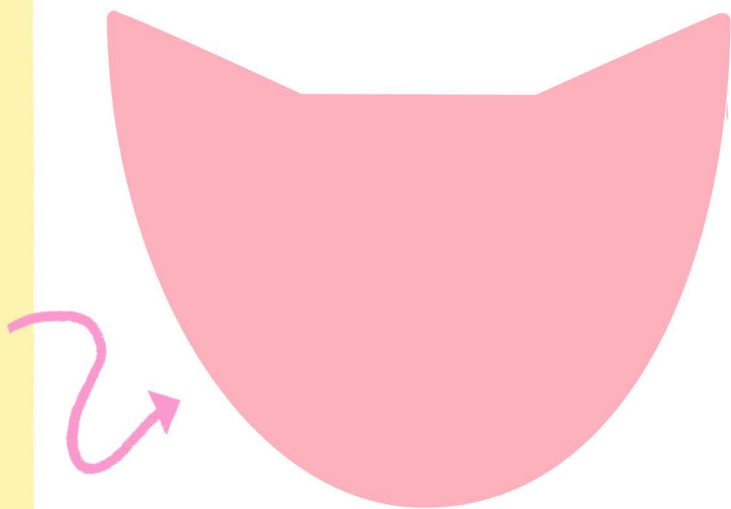

The objects around us haven't got a set colour. It all depends on the light in the room we're in and on the way our eyes react to the light. No two people see things the same way!



In Palazzo Strozzi's courtyard Eliasson has suspended an ellipse (a geometrical shape that looks like an elongated circle) covered in recycled plastic strips eight meters above the ground to create a very special effect.

Eliasson has also used this effect in the last rooms in the exhibition, which you can see when you go downstairs to the Strozziina.



What you see is an optical illusion known as a "moiré effect" that's created by our eyes, our movement, the light and the strips of fabric superimposed on one another.

Walk under the exhibit and look up at its surface. You'll see waves appear and move with you as you walk. What happens when you move faster? Or when you slow down?

Use the map to find your way around the exhibition rooms. The exhibition continues in Palazzo Strozzi's underground space known as the Strozzina. In the Strozzina the exhibit entitled *Your view matters* is open to visitors over 102 cm (3' 4") tall and is recommended for visitors over the age of eight.

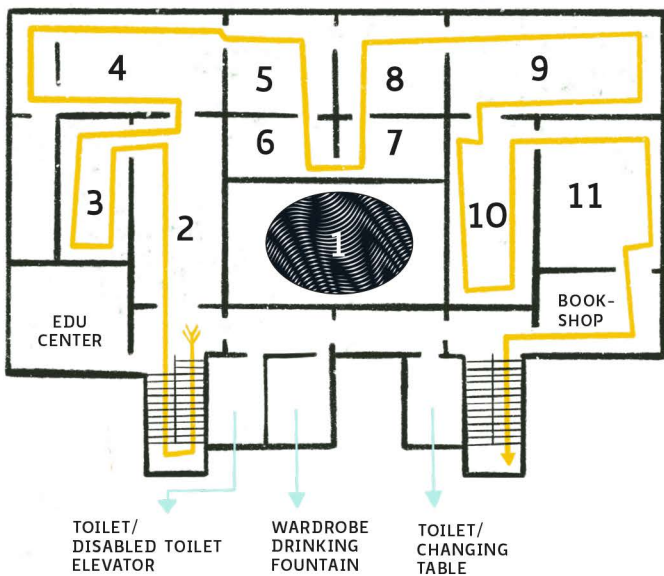

The Family Kit is a tool for exploring the exhibition following a tour designed for the whole family. The Kit is one of the Fondazione Palazzo Strozzi's initiatives designed to encourage participation on the part of visitors of all ages and to stimulate their interest in art of every kind.

The Family Kit  
is a Fondazione Palazzo Strozzi project  
Illustrations and graphic design by Simone Spellucci  
Easy Read Font biancoenero®