

# Anselm

# KIEFFER

## Angeli caduti

**FIRENZE  
PALAZZO  
STROZZI**

**22 MARZO/MARCH  
21 LUGLIO/JULY  
2024**

**MAPPA  
SENSORIALE  
E DEI SERVIZI**

***SENSORY  
AND FACILITY  
MAP***

Questa mappa è pensata per dare indicazioni sulla fruizione degli spazi di Palazzo Strozzi e le opere esposte in mostra. Sono segnalati ambienti con stimoli sensoriali e servizi in modo che ognuno possa organizzare al meglio la propria visita.

*This map is designed to suggest ways for you to get the most out of Palazzo Strozzi and the artworks on display in the exhibition.  
It shows areas with sensory stimuli and facilities to help you organise your visit as efficiently as possible.*

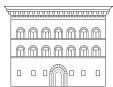

FONDAZIONE  
PALAZZO  
STROZZI

## Elenco delle opere

### List of works of art

#### Piano Nobile/First Floor

1. **Luzifer**, 2012-2023
2. **Für Antonin Artaud: Helagabale**, 2023  
**SOL INVICTUS Heliogabal** (Sole invito. Eliogabalo), 2023  
**Sol Invictus**, 1995
3. **La Scuola di Atene**, 2022  
**Vor Sokrates** (Prima di Socrate), 2022  
**Ave Maria**, 2022
4. **En Sof** (L'Infinito), 2016  
**Das Balder-Lied**, 2018  
**Danaë** (Danae), 2016
5. **Locus solus**, 2019-2023  
**Cynara**, 2023  
**A phantom city, phaked of philim pholk**, 2023  
**archaic zelotypia and the odium teleologicum**, 2023
6. **Vestralte Bilder** (Dipinti irradiati), 1983-2023
7. **Der Rhein**, 1982-2013  
**Dem unbekanntem Maler**, 2013  
**Hortus Philosophorum**, 1997-2011  
**Daphne**, 2008-2011  
**Ave Maria turris eburnea**, 2017  
**Nemesis**, 2017
8. **Heroische Sinnbilder**, 2009

#### Cortile/Courtyard

- 9 **Engelssturz**, 2022-2023

## Legenda

### Legend

- |   |  |   |   |
|---|--|---|---|
|  | Luce bassa<br>Low light  |    | Sedute<br>Sittings                                      |
|  | Sala che può dare problemi di equilibrio<br>Works that may induce balance issues |    | Ingresso facilitato<br>Facilitated entry                |
|  | Passaggio inferiore a 1 m<br>Width less than 1 m                                 |    | Guardaroba<br>Cloakroom                                 |
|  | Presenza di suono<br>Sound   |    | Fasciatoio<br>Baby changing table                       |
|  | Uscita di emergenza<br>Emergency exit  |    | Bagno accessibile<br>Accessible toilet                  |
|   |  |    | Fontanello<br>Water dispenser                           |
|   |  |    | Ascensore<br>Elevator                                   |
|   |  |   | Bagno<br>Toilet   |
|   |  |  | Caffé<br>Coffee House                                   |
|   |  |  | Rampa<br>Ramp   |
|   |  |  | Testi per ipovedenti<br>Texts for the visually impaired |

in caso di necessità contattare la biglietteria  
In case of need call the ticket office  
T. +39 055 2656368

 INGRESSO VIA STROZZI  
ENTRANCE VIA STROZZI

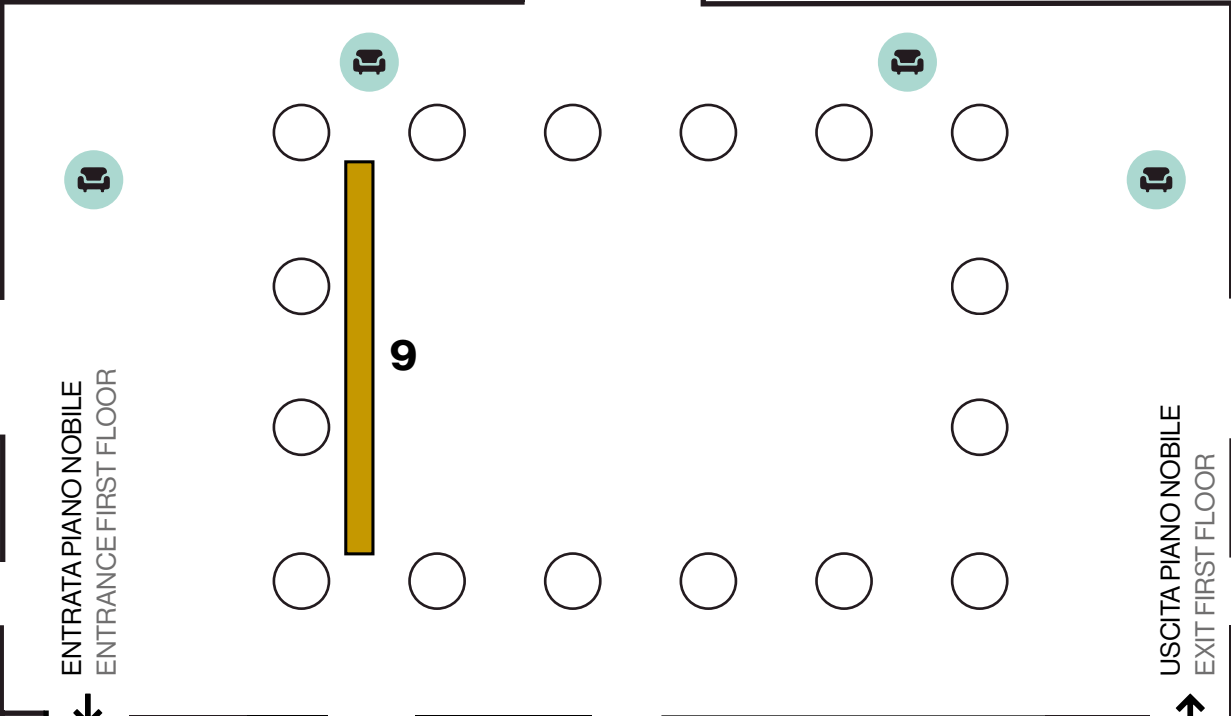
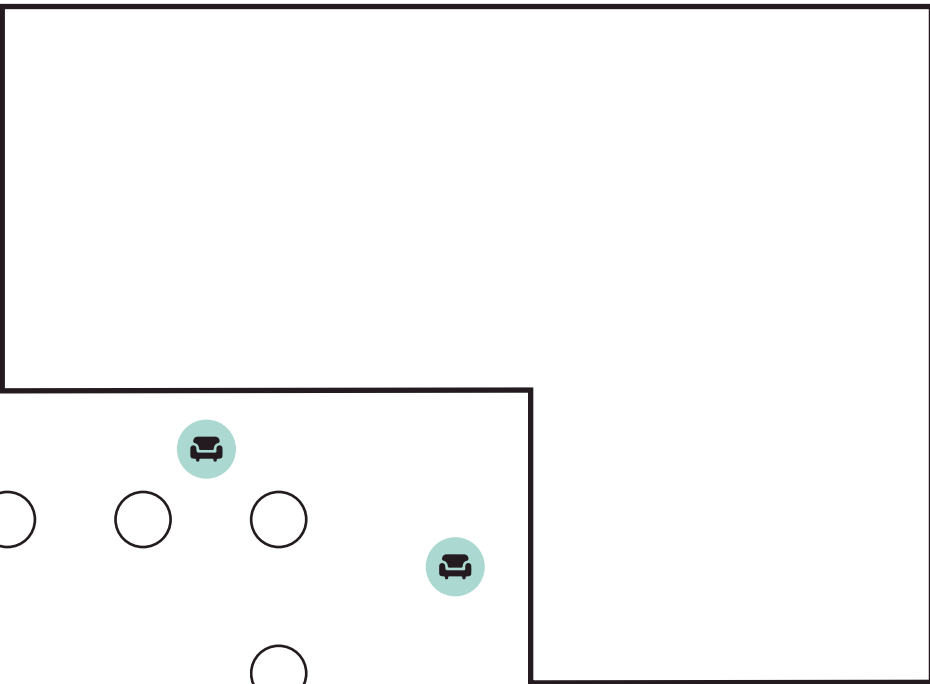
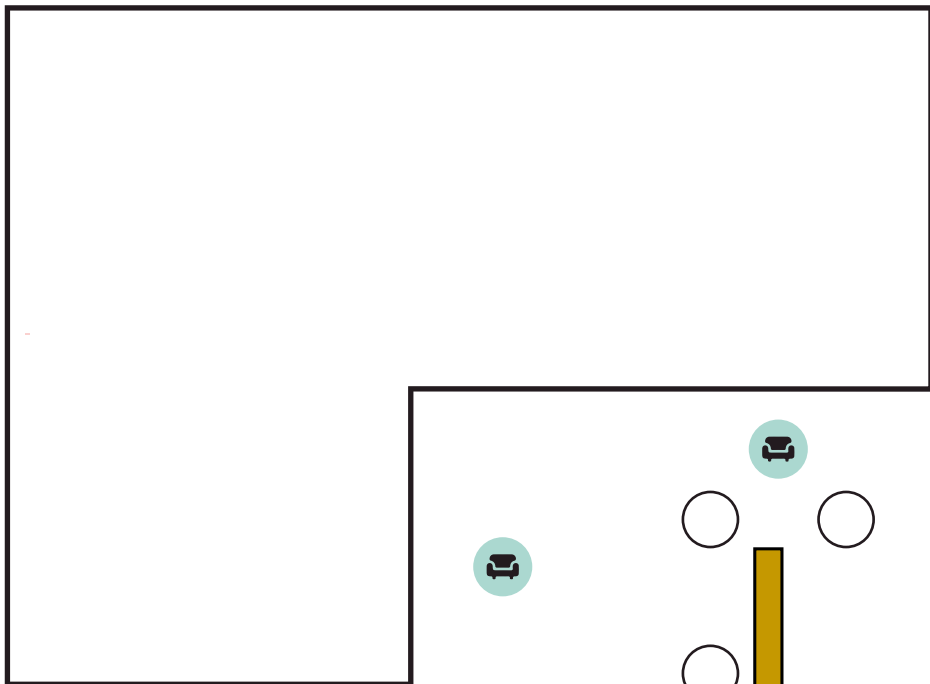

INGRESSO VIA TORNABUONI  
ENTRANCE VIA TORNABUONI

INGRESSO PIAZZA STROZZI  
ENTRANCE STROZZI SQUARE

BIGLIETTERIA  
TICKET OFFICE



BOOKSHOP

ENTRATA PIANO NOBILE  
ENTRANCE FIRST FLOOR

USCITA PIANO NOBILE  
EXIT FIRST FLOOR

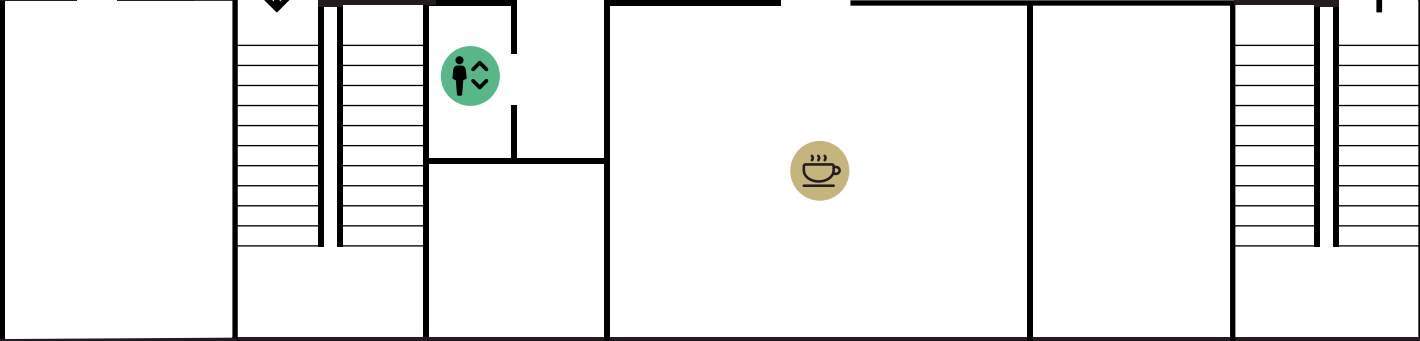

**Cortile**  
*Courtyard*

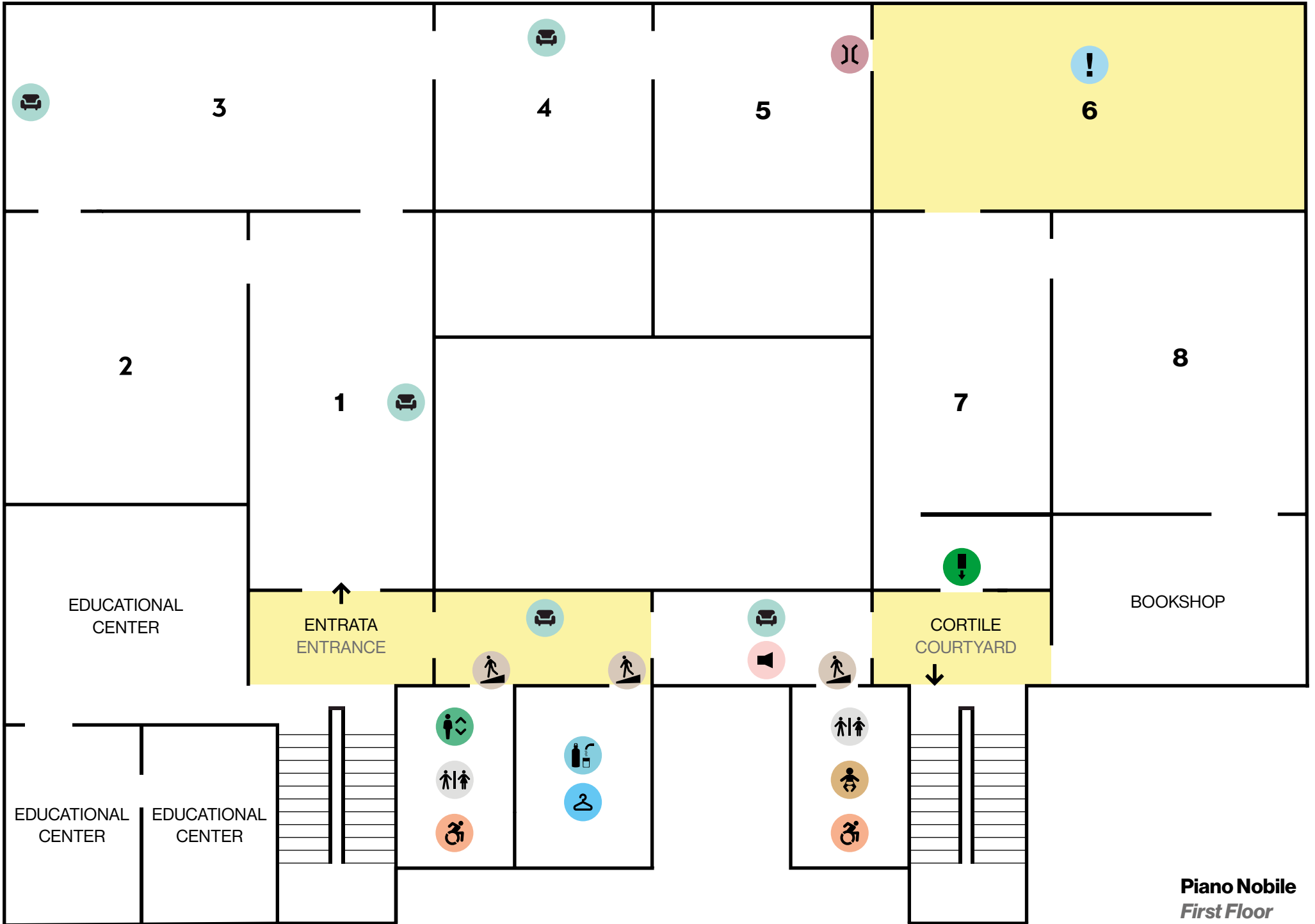

**Piano Nobile**  
*First Floor*